

# RAV4



**TOYOTA**

ALWAYS A  
**BETTER** WAY



**5** year  
TOYOTA  
WARRANTY

# Toyota RAV4. True to its original spirit.

The pioneering RAV4 created and defined a whole new category. Since then, successive generations have been improved upon and refined. But none has lost its soul. Today's RAV4 continues this tradition. It's even better to drive and it's loaded with features. But in its heart, remains true to its original spirit.



## **Design**

Athletic on the outside.  
Sophisticated on the inside.



## **Driving Dynamics**

Enjoy the drive. Designed with  
outstanding ride comfort and  
a dynamic driving experience  
whatever the conditions.



## **Package**

Class-leading space and a  
high degree of comfort.



## **Safety & Technology**

Equipped with intuitive  
technology from new  
Integrated Dynamic Drive  
System\* to ABS and VSC.

\* AWD only.





# Stay on track.

The RAV4 is designed for a safer, more enjoyable drive. The unique Integrated Dynamic Drive System\* sharpens driving performance and maximises traction over any terrain. This state-of-the-art technology ensures a smooth, stable and controlled drive in all weather conditions. Now, every journey is a pleasure.

\* AWD only.

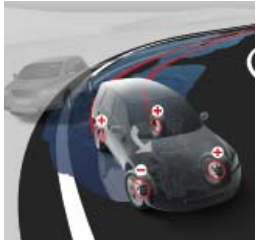

## Vehicle Stability Control (VSC)

VSC automatically activates each individual brake as needed and controls engine output to help maintain stability and prevent skidding when turning sharply or cornering on slippery road surfaces.



## Electric Power Steering (EPS)

EPS is optimised within the Integrated Dynamic Drive System (IDDS). At the start of a skid IDDS simultaneously changes the torque applied to the EPS to assist the driver in making the correct steering response to stay on course.



## All Wheel Drive (AWD)

The system pro-actively and variably distributes the torque between front and rear wheels to optimise traction and driving stability.

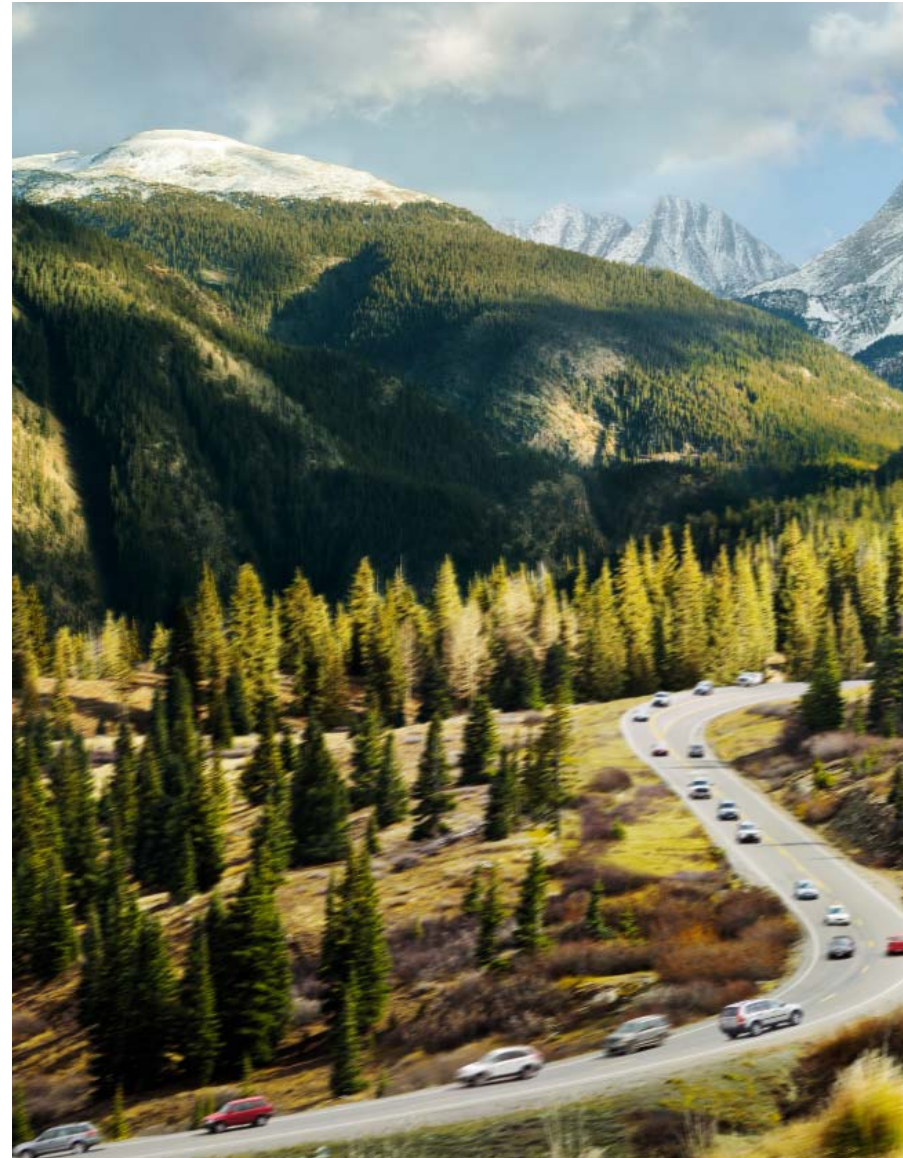











# Exhilaration at every turn.

The RAV4 has always been a joy to drive, and the Sport mode\* lets you make the most of its agile driving dynamics. When you switch to Sport mode, torque distribution between front and rear wheels, accelerator response, transmission control and steering feel adjust to sportier settings. So you enjoy a more exhilarating and dynamic driving experience.

\* AWD only.



## Designed to fit more in.

With class-leading boot space, the RAV4 can easily accommodate large items, making light work of your cargo needs. Lifting objects in or out is much easier too, thanks to the low loading height.

The RAV4 features a power back door\*, which can be automatically opened and closed at the flick of a switch. It also has a memory function which automatically retains the preferred opening height.

\* Icon and Invincible grades only.







# Are you sitting comfortably? You will be.

The RAV4 is comfortable, quiet and versatile. The refined cabin can easily accommodate five adults with best-in-class space for rear-seat passengers. High standards of finish and craftsmanship are evident throughout. And, of course, the RAV4 is as versatile as ever. Thanks to Toyota's Easy-Flat system the rear seats can be quickly and easily folded flat. The seats divide with a 60:40 split and each section can recline independently.

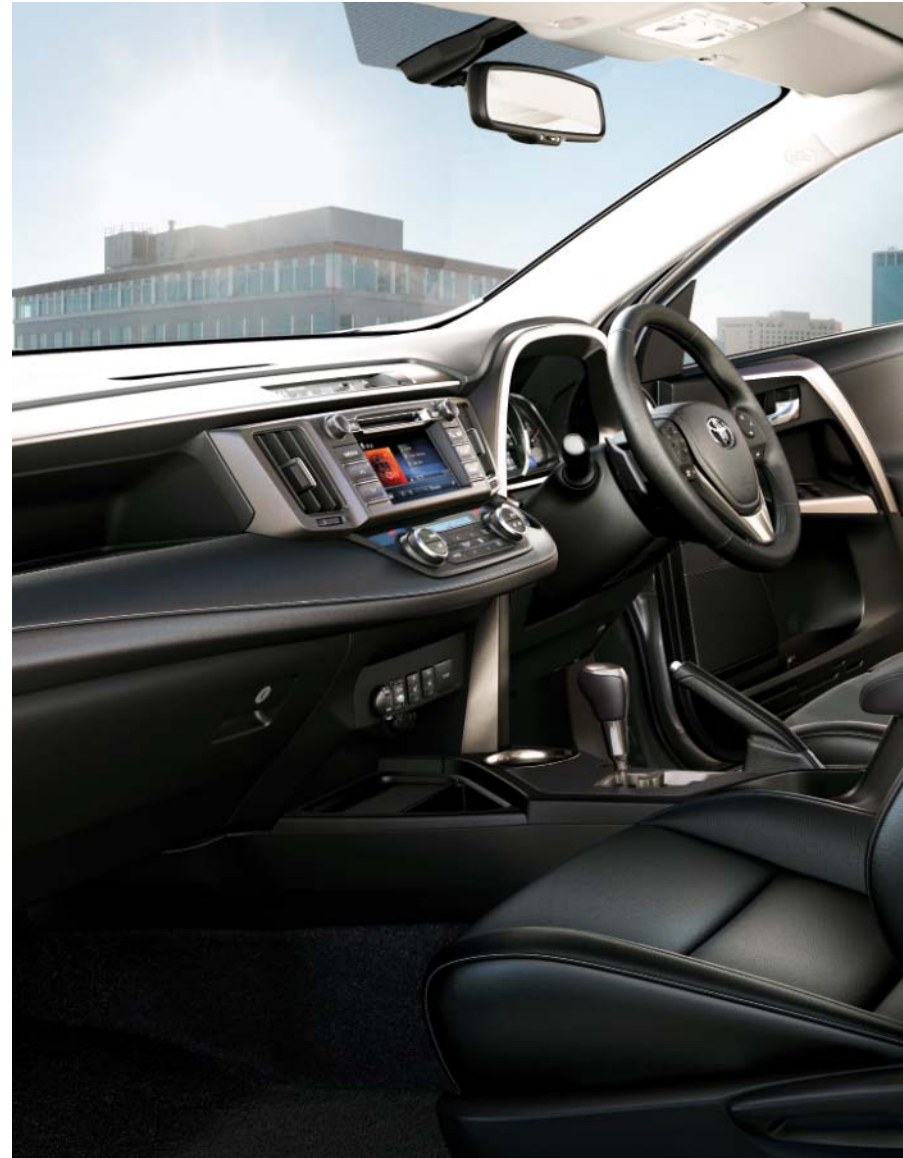





# A world of information and entertainment at your fingertips.



## TOYOTA TOUCH® 2

Toyota Touch® 2 multimedia system with an all new interface features an easy-to-use high-resolution colour touch-screen with drag and flick capabilities. With standard features like Bluetooth®, MP3 and iPod® connectivity as well as a multimedia management function, you'll never get bored on a journey, long or short. In addition, the standard rear-view camera function helps to take the stress out of parking and allows you to park easily and safely.

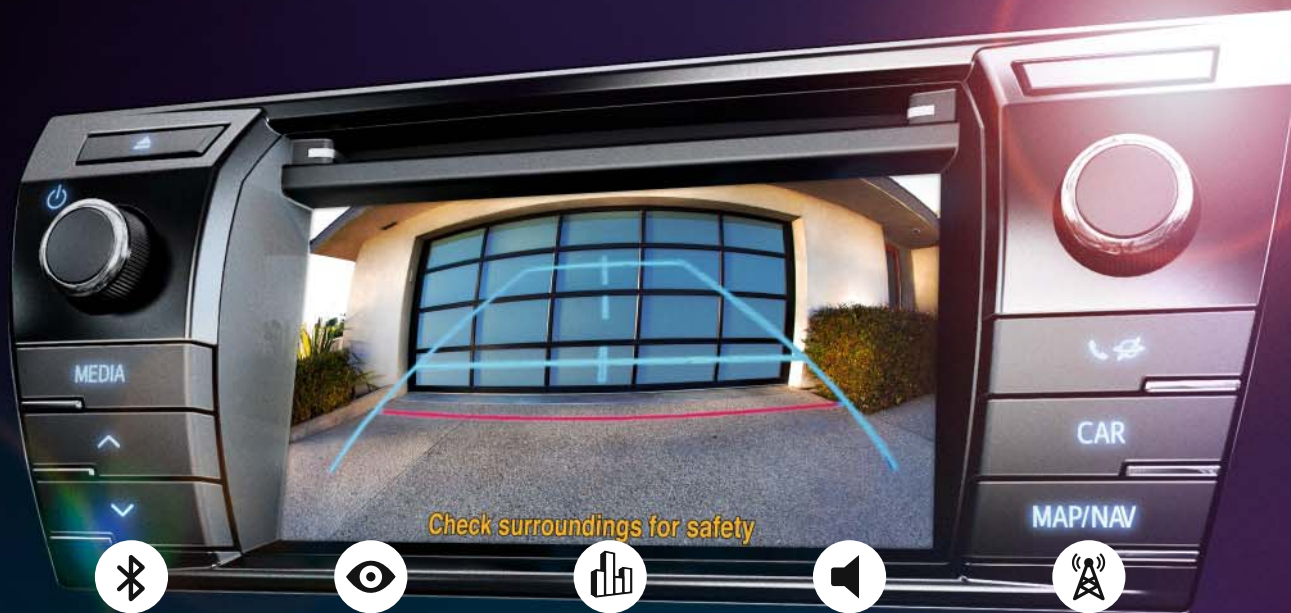

BLUETOOTH®

REAR-VIEW  
CAMERA

INFORMATION  
DISPLAY

MP3 & iPOD®  
CONNECTIVITY

MULTIMEDIA  
MANAGEMENT





## TOYOTA TOUCH® 2 WITH GO

Toyota Touch® 2 with Go adds enhanced full map navigation and class-leading connected services. Intuitive navigation provides clear visual display of signposts, junctions and lane guidance as well as speed limit and speed camera warning. Toyota Touch® 2 with Go delivers breakthrough connected services through its wide range of apps, bundled in the new Mobility Pack. All apps are pre-installed and will be provided free of charge for a 12-month period. More details of these great apps are shown on pages 14 and 15.



## TOYOTA TOUCH® 2 WITH GO PLUS\*

In addition to the functionality of Toyota Touch® 2 with Go, Toyota Touch® 2 with Go Plus provides 3-year free map updates, voice commands for audio phone book and navigation with one-shot address entry, text-to-speech, plus a host of other services and features.

\* Optional on Icon and Invincible grades only.



# Discover a world of innovative services:

Breakthrough connected services, bundled in the new Mobility Pack, are pre-installed in your system (Toyota Touch® 2 with Go and Toyota Touch® 2 with Go Plus) and are free for the first 12 months.

To activate, visit <https://customerportal.toyota-europe.com/login/index.html> and follow the simple steps to create your unique account. Once you have accessed your account, simply click on the



## Toyota Real-Time Traffic powered by TomTom

Works on real-time traffic flow, alerting you to slow-moving or queuing traffic, with the option to re-route your journey to avoid congestion and save time.



### TRAFFIC MONITOR

Provides a clear visual display of any traffic incidents or congestion along your route, estimating any delay to your journey.



### DETOUR OPTION

Offers specific information about traffic incidents along your route and suggests a detour option to save you time.



### DETOUR INFORMATION

Gives you on-screen graphic information of a detour, along with the delay and additional mileage incurred compared with your current route, for informed journey planning.



## Online Applications

Activate apps on your Toyota Touch® 2 with Go and Go Plus navigation systems to keep you informed and entertained. Apps are available for everything from the weather, to fuel costs and available parking places, helping you to drive safely and more economically.



Toyota Online services available on Toyota Touch® 2 with Go and Toyota Touch® 2 with Go Plus. Availability of Toyota Online services depends on compatibility with a Bluetooth®-equipped mobile phone (with DUN or PAN Bluetooth® profile) with a data plan. It also requires a mobile network operator that permits tethering.



# TOYOTA ONLINE

Toyota Touch® 2 quick link logo. This will take you directly to the newly improved multimedia portal to enjoy the benefits of the Mobility Pack, including innovative Toyota Real-Time Traffic powered by TomTom and Google Street View™.



## Google Street View™ and Panoramio™

Provides imagery of your current location, or a location of your choice, allowing you to start navigating directly from the image, so you'll never be lost.



### GOOGLE STREET VIEW™

Simply enter an address for a visual preview of any unknown destination. Six different Google Street View™ images offer a panoramic view to familiarize you with the location and promote peace of mind.



### PANORAMIO™ MAP

Maps city landmarks and places of interest to help you discover a new city easily and effortlessly. Simply choose your location of interest from the images shared by the Panoramio™ community.



### PANORAMIO™ IMAGES

View full image of your chosen location and let the navigation system guide you there, taking all the stress out of visiting unfamiliar places of interest.



## Online Local Search

Point Of Interest database enhanced by an online search facility. Connects to the internet via your phone, allowing you to search easily for the nearest fuel, restaurant, hospital or any type of place of interest.





# The power of choice.

Three engines are available, from the smooth 2.0 litre petrol, to the popular 2.2 litre diesel, as well as an amazingly efficient 2.0 litre diesel producing emissions from just 127 g/km CO<sub>2</sub>, meaning up to 57.6 miles per gallon, with competitive company car tax and no road tax in the first year.

Engine	Power	Fuel consumption*	CO <sub>2</sub> emissions*	Acceleration	Available on
<b>2.0 litre Petrol</b> CVT automatic AWD	<b>151</b> DIN hp	<b>41.5</b> mpg	<b>157</b> g/km	<b>10.7</b> seconds 0–62 mph	Icon, Invincible
<b>2.0 litre Diesel</b> 6-speed manual, Stop & Start 2WD	<b>124</b> DIN hp	<b>57.6</b> mpg	<b>127/128<sup>§</sup></b> g/km	<b>10.5</b> seconds 0–62 mph	Active, Business Edition, Icon <sup>§</sup> , Invincible <sup>§</sup>
<b>2.0 litre Diesel</b> 6-speed manual AWD	<b>124</b> DIN hp	<b>53.0</b> mpg	<b>137</b> g/km	<b>10.5</b> seconds 0–62 mph	Icon, Invincible
<b>2.2 litre Diesel</b> 6-speed manual AWD	<b>150</b> DIN hp	<b>49.6</b> mpg	<b>149</b> g/km	<b>9.6</b> seconds 0–62 mph	Icon, Invincible
<b>2.2 litre Diesel</b> 6-speed automatic AWD	<b>150</b> DIN hp	<b>42.2</b> mpg	<b>176</b> g/km	<b>10.0</b> seconds 0–62 mph	Icon, Invincible

CVT = Continuously Variable Transmission    AWD = All Wheel Drive    \* Combined cycle.  
Mpg and CO<sub>2</sub> data sourced from EU tests. For more information please see the back cover.

<sup>§</sup> Based on 18" wheels.

# RAV4 range – exteriors



## Active (2WD only)

### Main features

- 17" chrome alloy wheels
- LED daytime running lights
- Rear privacy glass
- Front fog lamps
- Body-coloured, heated, power-adjustable mirrors with integrated indicators
- Body-coloured door handles
- Space saver spare wheel

### Options:

- Style Pack
- Protection Pack
- Tow bar with either 7- or 13-pin wiring



## Business Edition (2WD only)

### Main features (additional to Active grade)

- Chrome front bumper trim

### Options:

- Style Pack
- Protection Pack
- Tow bar with either 7- or 13-pin wiring





## Icon

### Main features (additional to Business Edition grade)

- 18" two-tone alloy wheels
- Keyless entry
- Power back door with memory setting
- Retractable mirrors

### Options:

- Alloy wheel upgrades
- Style Pack
- Protection Pack
- Tow bar with either 7- or 13-pin wiring



## Invincible

### Main features (additional to Icon grade)

- Roof rails
- Front and rear underruns\*
- Front and rear parking sensors

### Options:

- Alloy wheel upgrades
- Style Pack
- Tow bar with either 7- or 13-pin wiring

\* Underruns will be silver on all colours except Pearl White, which will receive matching underruns.

# RAV4 range – interiors

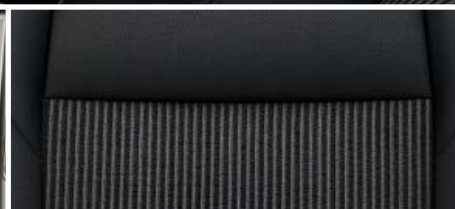

## Active (2WD only)

### Main features

- Manual air conditioning
- Bluetooth® connectivity
- 4-speaker audio (CD/Aux/USB)
- Steering wheel audio and Bluetooth® controls
- Kantara fabric seat trim
- Illuminated entry system
- Follow-Me-Home headlight system
- Power windows (front & rear)
- Tyre Pressure Warning System (TPWS)

### Options:

- Leather interior
- Rear entertainment system

## Business Edition (2WD only)

### Main features (additional to Active grade)

- Toyota Touch® 2 with Go: touchscreen multimedia system
  - 6-speaker audio (CD/Aux/USB)
  - DAB radio
  - Rear-view camera
  - Navigation
- Leather steering wheel with audio and Bluetooth® controls
- Cruise control
- Dual-zone Climate Control air conditioning

- Rain-sensing wipers
- Dusk-sensing headlamps
- Auto-dimming rear-view mirror
- Beaumont fabric seat trim
- Leather-like door trim and upper instrument panel

### Options:

- Leather interior
- Rear entertainment system





## Icon

### Main features (additional to Business Edition grade)\*

- Push-button start

### Options:

- Leather interior
- Rear entertainment system
- Toyota Touch® 2 with Go navigation
- Toyota Touch® 2 with Go Plus navigation

\* Excludes Toyota Touch® 2 with Go navigation.

## Invincible

### Main features (additional to Icon grade)

- Exclusive Berkeley full leather seats
- Optional Berkeley beige leather seats and trim
- Heated front seats
- Power slide driver's seat
- Power lumbar driver's seat
- Console box with leather cover

### Options:

- Rear entertainment system
- Toyota Touch® 2 with Go navigation
- Toyota Touch® 2 with Go Plus navigation

# Colours



**040 Pure White**



**070 Pearl White\***



**1H2 Deep Titanium<sup>§</sup>**



**209 Eclipse Black<sup>§</sup>**

\* Pearlescent paint.

<sup>§</sup> Metallic paint.





**1F7 Tyrol Silver<sup>§</sup>**



**1G3 Decuma Grey<sup>§</sup>**



**3R3 Vermillion Red<sup>§</sup>**



**4U5 Mahogany<sup>§</sup>**

# Wheels and trims



**17" alloy wheels**

Standard on Active and Business Edition



**18" two-tone alloy wheels**

Standard on Icon and Invincible



**18" Pitlane II alloy wheels, silver**

Accessory option on Icon and Invincible



**18" Pitlane II alloy wheels, two-tone anthracite**

Accessory option on Icon and Invincible



**18" Pitlane II alloy wheels, anthracite**

Accessory option on Icon and Invincible



**18" Pitlane II alloy wheels, matt black**

Accessory option on Icon and Invincible





**Kantara black cloth**  
Standard on Active



**Beaumont black cloth**  
Standard on Business  
Edition and Icon



**Markham black leather**  
With heated front seats;  
optional on Active, Business  
Edition and Icon



**Berkeley black leather**  
Standard on Invincible



**Berkeley beige leather**  
Optional on Invincible\*

\* Available in conjunction with exterior colours: Eclipse Black (209), Pearl White (070), Decuma Grey (1G3), Vermillion Red (3R3) and Mahogany (4U5) only.

# Options

Toyota RAV4 accessory packs offer individuality, convenience and value. Whether your preference is SUV personality, added style or pure functionality, each pack provides flexibility to tailor your car to the life you lead.



## Style Pack

### 1. Rear chrome trim

A dash of chrome to highlight your car's distinctive rear-end design.

### 2. Side sills with chrome trim insert

Protection for your car's side panels against minor scrapes combined with a stylish chrome inlay.

### 3. Side step

With a non-slip surface for easier access to your car. Finished in matt black.

### 4. Front fog chrome surround

The contour is designed to fit neatly around your fog lamps. Its bright chrome finish adds a stylish detail to the front of your vehicle.

# Options

## Rear Entertainment Packs

A new rear-seat Toyota entertainment system that you can configure for complete flexibility—featuring a multi-purpose docking station that is compatible with a 7" DVD player and iPad® holder. The DVD player can be configured in a master/slave arrangement, where one DVD plays on both screens, or as master/master, where each screen can play a different DVD. The iPad® holder can be mounted either landscape or portrait, to exactly match your requirements. The dock itself provides all the power to the attachments, with no visible wires and does not affect anti-whiplash head restraints for those sitting in the front seats.

Wireless headphones are not included in the packs, although are available as an optional item.



### DVD player (shown left)

- Features a 7" screen with stereo sound and a remote control, so children can watch without adjusting their seat belts.
- Can be combined as either master/master or master/slave configurations.
- Compatible with wireless headphones for superb stereo sound.
- Can be removed from car and used at home.

### iPad® holder (shown above)

- Clips into docking station for a secure holder for your iPad®.
- Charges your iPad® while docked.
- Can be combined with WiFi hotspot (sold separately) to allow your iPad® to connect to the internet.

### Optional wireless headphones (shown above left)

- Superb stereo sound.
- Independent volume control.
- Automatically shut down to preserve battery life.

### Security

- DVD and iPad® holder easily removed for security when not in use.

### Safety

- Meets European crash and impact testing standards.
- Does not affect anti-whiplash seat head restraints.
- Integrated installation with no trailing wires or cords.

Compatible with iPad® generations 2, 3 and 4 only. iPad® is a trademark of Apple Inc., registered in the US and other countries.



# Options

## Protection Pack\*

### 1. Parking aid system

The RAV4 is wonderfully easy to park. Even so, when space is tight, you'll find the guidance given by the Toyota parking aid system a big help in avoiding accidental scrapes.

Sensors added to the front and rear bumpers are linked to in-car alarms that give a progressively louder warning the closer you get to an obstacle. Conveniently, the front and rear alarms have different sounds and can be switched off when not required.

1.

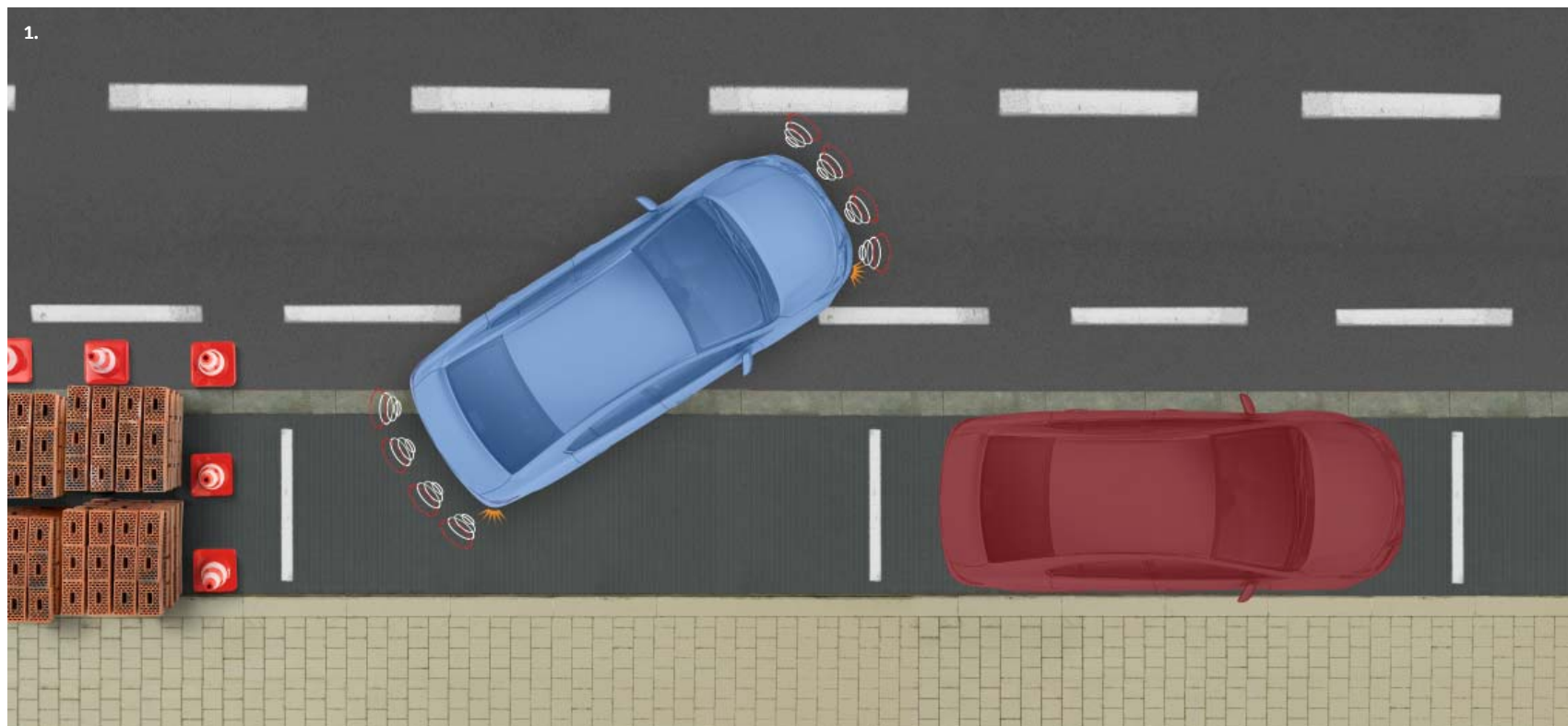

## 2. Rear bumper protection plate

A polished aluminium-effect appearance also providing tough paintwork protection when loading or unloading the boot.



## 3. Bootliner

Tailored to fit the boot of your vehicle and provide tough waterproof protection against dirt and spills. The design of the liner incorporates a raised lip to prevent liquid leaking over the edges and also features a special anti-slip surface pattern to help stop luggage moving about.



\* Protection Pack available on Active, Business Edition and Icon.

# Options

## Towing

### Tow bar – detachable and fixed

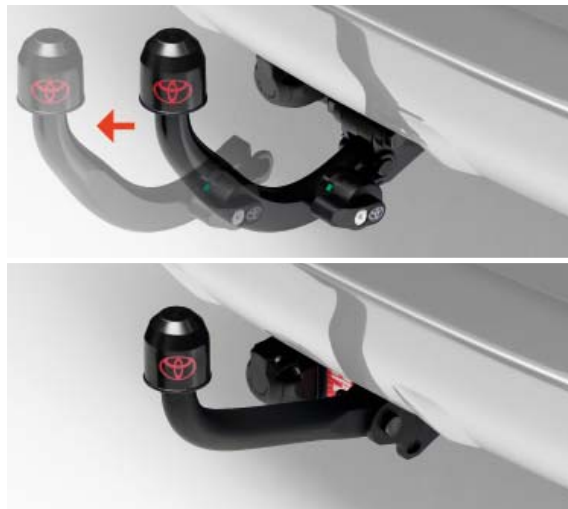

Toyota tow bars are available with a fixed or detachable hook. Both provide a strong towing capability and will support the Toyota rear-mounted bicycle holder.

#### Features

- 1500–2000 kg towing capacity depending on engine type (the tow bar is designed for your car's maximum towing capacity).
- Supplied with a protective tow-ball cap bearing the Toyota logo.
- All Toyota tow bars can be used to support the 2-bicycle version of the Toyota rear bicycle holder.
- With the detachable tow bar, a smart plastic cover is supplied to place over the base when the hook is removed.
- On the detachable tow bar, the hook attaches or removes by means of a turning knob that also incorporates a security lock.

### Tow bar wiring harness

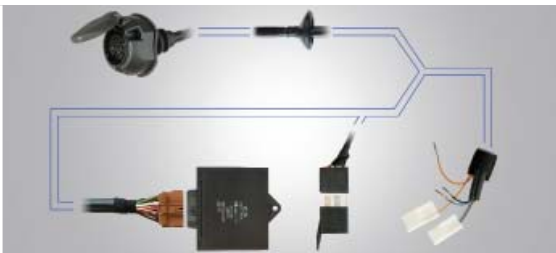

Safety for you and your car is at the heart of the Toyota tow bar wiring harness. Individually designed for each Toyota model, the harness seamlessly integrates your car's lights and signals with those on a towed trailer or rear bicycle holder.

#### Features

- The harness has independent circuitry and a fused module to eliminate the risk of overloading your car's existing electrical system.
- The fused module prevents a fault in the trailer's circuitry affecting your car's systems. For instance, your car's indicators will continue working even if those on the trailer fail.
- Toyota specialists designed the cable route to safely avoid contact with moving car parts, heat, irregular surfaces and metal edges.
- There are no loose or hanging cables that could catch on road obstacles or interfere when loading or unloading the boot.
- Strategic reinforced cable protection guards against accidental damage and the consequent risks of lighting failure or fire caused by electrical shorting.
- Available with a 7- or 13-pin socket.

### Socket adapters



If you have an existing trailer or rear bicycle holder, or perhaps you want to hire a trailer when you travel in another country, you may find that the plug socket is different to that on your new car. Such a problem is easily resolved! A Toyota socket adapter enables you to safely and securely connect your car's tow bar wiring harness to that of a trailer or bicycle holder even if the plugs don't match.

Toyota adapters are designed to provide a durable connection between different types of plug sockets. They are available in three versions:

- 7-pin (car) to 13-pin (trailer).
- 13-pin (car) to 7-pin (trailer).
- 13-pin (car) to 12N-12S double socket (trailer).



# Individual accessories

## Technology

A range of individual accessories are also available for your new RAV4, allowing you to personalise your vehicle even further to your own bespoke requirements. These can offer greater protection, add further stylish touches, or provide additional carrying capacity for your new car. All of these additional items are available from your local Toyota Centre.



### Toyota Hotspot

As the name suggests, Toyota Hotspot gives you internet access and effectively turns your car into a mobile hotspot. Simply load the Toyota Hotspot box with a SIM card of your choice and, as long as you're in a 3G area, you'll have instant access to the internet and all the web has to offer.

The Toyota Hotspot connects up to five WiFi-capable devices including laptops, tablets, smartphones, iPads, iPhones and game systems and also enables in-car interaction between them. Importantly, the Toyota Hotspot is wired into your car's electrical system to ensure a constant power supply.

- Designed specifically for in-car use and the special demands of temperature variation and vibration.
- Automotive design high speed dual antenna that enhances mobile reception and minimises 3G connection problems.
- Open to any GSM operator and so allows you to use a SIM card of your choice. It will accept a dedicated data transfer card and, when travelling abroad, you can fit a local card to avoid roaming charges or enable roaming on your card.
- Over-the-air software updating happens almost automatically.
- User-friendly web interface allows personalisation of Toyota Hotspot functions such as the connection parameters.
- Easy to use with a simple on/off switch and coloured diodes to inform of status and activity.
- Securely mounted within your car to avoid trailing wires.
- Free from the technical problems associated with using a smartphone as a hotspot and also the restrictions imposed by internet providers. For example, the Toyota Hotspot does not limit you to just one user surfing the net.
- Covered by a Toyota warranty.

# Individual accessories

## Exterior style

### 1. Front guard and underrun\*

The front guard with integrated underrun emboldens your car with a tough sturdy look and protects against stone chips. Finished in Matt Black and Chrome.

### 2. Front under-guard\*

Great-looking protection against stone chips. Finished in Matt Black and Chrome.

### 3. Rear under-guard\*

Tough yet stylish guard for the rear underbody. Finished in Satin Silver.

### 4. Chrome rear light surround

Introduces a stylish chrome surround to the rear light cluster.

\* Available on all grades except Invincible.



1./2.

## Protection

### 1. Dog guard

The ideal accessory to fit if you regularly carry a dog in your car but don't want it jumping all over the seats as you drive, or if you want to ensure your luggage cannot fall forwards into the passenger cabin.

### 2. Boot divider for dog guard

Combines with the dog guard to maximise carrying flexibility. It can be used to divide the boot space for two dogs, a dog and luggage, or different types of luggage. (Can only be fitted in conjunction with the dog guard.)





# Individual accessories

## Protection

### 1. Steel rear bumper protection plate

A prestigious polished steel appearance also providing tough paintwork protection when loading or unloading the boot.



### 2. Boot liner

Durable waterproof plastic with a raised lip and non-slip surface pattern. Ideal for a busy outdoor lifestyle.

### 3. Rubber floor mats

Ultra-strong protection for your car's carpets against mud, dirt and sand. Special fixing devices hold the driver's mat firmly in place.

### 4. Side mouldings

The good-looking way to guard door panels against minor damage. In black or body colour painted to match your car.



#### 5. Luxury textile floor mats

Soft textile carpeting on a hard-wearing padded base for maximum comfort and protection for your car's carpets. Tailored to fit and with floor-fixing devices for the driver's mat.

#### 6. Mud flaps

The design minimises water, mud and stones spraying onto your car's body. Available for the front and rear. (Not available with side steps.)

#### 7. Bumper corner protectors

Ideally located at the front and rear bumper corners to protect against accidental scrapes. In black or body colour, painted to match your car.

6.



7.



#### 8. Wind deflectors

Aerodynamically shaped to reduce in-cabin wind noise and buffeting when driving with open windows. For the front and rear windows.

#### 9. Door handle protection film

Virtually invisible, yet providing tough protection against scratching by gloves, rings and keys around the door handle.

8.



9.



# Individual accessories

## Touring

Toyota touring accessories are custom-designed to make even more of the RAV4's sense of adventure. Choices including roof-top storage and bicycle holders add extra capacity. This means you can quickly and safely load up and go wherever your passion takes you.

### Roof rails\*

You may consider it preferable to fit permanent roof rails if you intend to regularly use the roof of your RAV4 for transporting large or bulky items. With roof rails in place, you can then quickly install lockable crossbars and choose from a wide range of optional attachments for carrying specific items.

\* Available on all grades except Invincible.

### Crossbars

For use in combination with Toyota roof rails. The crossbars lock onto the rails and provide a base for the range of specialised Toyota carrying attachments such as ski and bicycle holders and luggage boxes.





### Ski boxes

Thule Motion 800 – gloss black (also in gloss silver)



Thule Pacific 700 – silver grey



#### For those big snow holidays

Thule ski boxes have been custom-designed to exactly the right length, shape and capacity for securely carrying all your winter sports accessories.

#### Thule Motion 800

Dimensions: 205 cm L x 84 cm W x 45 cm H

Internal volume: 460 litres

Maximum content weight: 75 kg\*

Holds: 5–7 pairs of skis, 4–5 snowboards

Weight: 21 kg

#### Thule Pacific 700

Dimensions: 232 cm L x 70 cm W x 40 cm H

Internal volume: 420 litres

Maximum content weight: 50 kg\*

Holds: 6 pairs of skis, 4 snowboards

Weight: 15 kg

#### Features

- Opens from both sides for easy loading and unloading.
- High security multi-point central locking system.
- Grip-friendly key cannot be removed until all the locking points are closed.
- Fits the Toyota roof rack and Toyota crossbars on roof rails.
- Internal straps for securing the box contents.
- Made of colour-fast UV-resistant ABS plastic.

### Ski & snowboard holders

Large ski and snowboard holder



#### Simply load and go

The holders install easily and lock securely so you can quickly load skis and snowboards whenever the inspiration takes you. They fit onto the Toyota roof rack and Toyota crossbars on roof rails.

#### Medium size holder



#### Large size holder

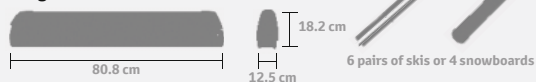

#### Features

- Weight: 3.2 kg medium, 4.2 kg large.
- Skis secured between soft rubber for grip and to prevent damage.
- Central locking system for maximum security.
- Push release for easy opening with gloved hands.
- Large holder slides to the car side for easy loading and unloading.

### Luggage box

Thule Pacific 200 – silver grey



#### Just right for holidays

For jackets and dresses, shorts, shoes and playthings: a Thule luggage box is perfect to carry all you need for those big holidays and weekends away.

#### Thule Pacific 200

Dimensions: 175 cm L x 82 cm W x 45 cm H

Internal volume: 410 litres

Maximum content weight: 50 kg\*

Weight: 14 kg

#### Features

- Opens from both sides for convenient loading and unloading.
- High security multi-point central locking system.
- Grip-friendly key cannot be removed until all the locking points are closed.
- Fits the Toyota roof rack and Toyota crossbars on roof rails.
- Internal straps for securing the box contents.
- Made of colour-fast UV-resistant ABS plastic.

\* Maximum content weight is based on the RAV4's maximum roof load capacity.



**Rear-mounted multi-capacity**

For secure transportation and easy loading and unloading. The clamp-mounted holder is a universal solution that attaches to all genuine Toyota tow bars.

**Key product highlights:**

**Clamp-mounted rear bike holder**

Load capacity (bikes)	2
Total load capacity (kg)	36
Dimensions L x W (cm)	105 x 58
Weight of unit (kg)	14
Fits frame dimensions (mm)	22–70
Vehicle's holding system	Tow bar: fixed, detachable horizontal & vertical
Powerplug/Rear lights	7-pin or 13-pin
Safety	Locks bike to carrier
	Locks carrier to car
	One-key system compatible
Fulfils city crash norm	Yes
Miscellaneous	Maximum weight per bike: 20 kg. Fits bikes with disc brakes. Tiltable for easy access to boot.

**Quick and easy roof mounting**

The lockable lightweight aluminium design attaches to Toyota crossbars and has secure wheel and frame grips. Conveniently, the frame grip can be adjusted at roof height.

1
15
159 x 29
4.4
20–80
Fits square and extruded aluminium crossbars
–
Locks bike to carrier
Locks carrier to car
–
Yes
UV-resistant plastic. Fits wheel width up to 5.6 cm.

# Safety

Caring for young passengers needs careful thought. Be assured, with Toyota child restraint seats you have individual options for each age group.

Nothing is left to chance with a Toyota child restraint seat. The fixings are secure, the fabrics are robust and the design offers both safety and comfort. Whether travelling near or far, you can be sure your most precious cargo will be well protected.



Name	Baby-Safe Plus	Baby-Safe Belted Base	Duo Plus	Kid
Suitable for	From birth up to 13 kg (up to 12/15 months)	Compatible with Baby-Safe Plus seat	From 9 to 18 kg (8 months to 4 years)	From 15 to 36 kg (4 to 12 years)
Installation	Baby-Safe belted base or seat-belt	Seat-belt	ISOFIX or seat-belt	Seat-belt
Weight (kg)	3.9	6.0	9.0	5.8
Dimensions H x L x D (cm)	57 x 44 x 65	62 x 37 x 86 (while extended)	60 x 46 x 49	67 x 51 x 46



# Specifications

ENVIRONMENTAL PERFORMANCE	2.0 I Valvematic Auto (CVT), AWD	2.0 I D-4D Man (6-speed), 2WD	2.0 I D-4D Man (6-speed), AWD	2.2 I D-4D 150 Man (6-speed), AWD	2.2 I D-4D 150 Auto (6-speed), AWD
<b>Fuel consumption</b>					
Combined driving (mpg)	41.5	57.6	53.0	49.6	42.2
Urban driving (mpg)	33.6	49.6	44.8	40.9	34.9
Extra urban driving (mpg)	47.9	62.8–64.2	60.1	56.5	47.9
Fuel tank capacity (litres)	60	60	60	60	60
<b>Carbon dioxide, CO<sub>2</sub></b>					
Combined driving (g/km)	157	127–128	137	149	176
Urban driving (g/km)	194	149	163	181	213
Extra urban driving (g/km)	137	115–117	123	131	155
<b>Exhaust emissions</b>					
Euro class	Euro 6	Euro 5	Euro 5	Euro 5	Euro 5
Carbon monoxide, CO (mg/km)	308.7	271.3	271.3	210.5	55.3
Nitrogen oxides, NOx (mg/km)	23.5	135.0	135.0	122.5	74.6
Hydrocarbons, THC & Nitrogen oxides, NOx (mg/km)	–	153.7	153.7	146.0	81.9
Smoke particulates (mg/km)	–	0.69	0.69	0.96	1.83
Hydrocarbons, THC (mg/km)	41.7	–	–	–	–
Hydrocarbons, NMHC (mg/km)	37.8	–	–	–	–
<b>Noise (drive-by)</b>					
dB(A)	68.8	68.3	68.3	69.2	69.6

**Quoted mpg and CO<sub>2</sub> figures:** All mpg and CO<sub>2</sub> emissions figures stated in this brochure are sourced from official EU-regulated tests. These are provided for comparability purposes and may not reflect your actual driving experience. For further information please see the back cover of this brochure.

ENGINE	2.0 I Valvematic Auto (CVT), AWD	2.0 I D-4D Man (6-speed), 2WD	2.0 I D-4D Man (6-speed), AWD	2.2 I D-4D 150 Man (6-speed), Auto (6-speed), AWD
Number of cylinders	4 in line	4 in line	4 in line	4 in line
Valve mechanism	16-valve DOHC with Valvematic & Dual VVT-i	16-valve DOHC	16-valve DOHC	16-valve DOHC
Fuel system	Electronic fuel injection	Direct injection with common- rail system with piezo injector	Direct injection with common- rail system with piezo injector	Direct injection with common- rail system with piezo injector
Displacement (cc)	1987	1998	1998	2231
Bore x stroke (mm x mm)	80.5 x 97.6	86.0 x 86.0	86.0 x 86.0	86.0 x 96.0
Compression ratio	10.0:1	15.8:1	15.8:1	15.7:1
Maximum power output (DIN hp)	151/6200	124/3600	124/3600	150/3600
Maximum torque (Nm/rpm)	195/4000	310/1600–2400	310/1600–2400	340/2000–2800

PERFORMANCE	2.0 I Valvematic Auto (CVT), AWD	2.0 I D-4D Man (6-speed), 2WD	2.0 I D-4D Man (6-speed), AWD	2.2 I D-4D 150 Man (6-speed), AWD	2.2 I D-4D 150 Auto (6-speed), AWD
Maximum speed (mph)	115	112	112	118	115
0–62 mph (secs)	10.7	10.5	10.5	9.6	10.0
Drag coefficient	0.323	0.314	0.314	0.314	0.314

## BRAKES

Front	Ventilated disc
Rear	Disc

## SUSPENSION

Front	MacPherson strut
Rear	Double wishbone

CVT = Continuously Variable Transmission

AWD = All Wheel Drive

# Specifications

DIMENSIONS & WEIGHTS	2.0 I Valvematic Auto (CVT), AWD	2.0 I D-4D Man (6-speed), 2WD	2.0 I D-4D Man (6-speed), AWD	2.2 I D-4D 150 Man (6-speed), AWD	2.2 I D-4D 150 Auto (6-speed), AWD
Exterior length (mm)	4570	4570	4570	4570	4570
Exterior width (mm)	1845	1845	1845	1845	1845
Exterior height (mm)	1660	1660/1705*	1660/1705*	1660/1705*	1660/1705*
Front overhang (mm)	910	910	910	910	910
Rear overhang (mm)	1000	1000	1000	1000	1000
Wheelbase (mm)	2660	2660	2660	2660	2660
Turning circle – tyre (m)	5.3 <sup>9</sup> /5.6	5.3 <sup>9</sup> /5.6	5.3 <sup>9</sup> /5.6	5.3 <sup>9</sup> /5.6	5.3 <sup>9</sup> /5.6
Interior length (mm)	1935	1935	1935	1935	1935
Interior width (mm)	1505	1505	1505	1505	1505
Interior height (mm)	1220/1150°	1220/1150°	1220/1150°	1220/1150°	1220/1150°
Luggage overall length, rear seat up (mm)	1025	1025	1025	1025	1025
Luggage overall width (mm)	1335	1335	1335	1335	1335
VDA luggage capacity, up to tonneau cover, rear seat up (litres)	647	647	647	647	647
Gross vehicle weight (kg)	2110	2135	2190	2220	2240
Kerb weight (kg)	1520–1605/ 1520–1615	1535–1605/1535– 1615/1535–1625	1585–1670/ 1585–1675	1605–1695/ 1605–1710	1645–1720/ 1645–1735
Towing capacity with brakes (kg)	1500	1600	1600	2000	1800
Towing capacity without brakes (kg)	750	750	750	750	750
Front tread (mm)	1560	1560	1560	1560	1560
Rear tread (mm)	1560	1560	1560	1560	1560
Luggage capacity up to tonneau cover (litres)	647	647	647	647	647
Luggage capacity up to roof, rear seat down (litres)	1846	1846	1846	1846	1846



## TYRES & WHEELS

	Active (2WD only)	Business Edition (2WD only)	Icon	Invincible
17" alloy wheels (5-spoke)	●	●	—	—
18" alloy wheels (two-tone)	—	—	●	●
Space Saver spare wheel	●	●	●	●

● = Standard

— = Not available

CVT = Continuously Variable Transmission

AWD = All Wheel Drive

\* Invincible grade.

§ 17" wheels only.

° With sunroof.



1560 mm

1845 mm



1000 mm

2660 mm

910 mm

4570 mm

1660/1705\* mm



1560 mm

1845 mm

Widths shown do not include door mirrors.

# Equipment

EXTERIOR	Active (2WD only)	Business Edition (2WD only)	Icon	Invincible
Daytime running lights (LED type)	●	●	●	●
Multi-reflector halogen headlamps	●	●	●	●
Follow-Me-Home headlights	●	●	●	●
Front fog lamps	●	●	●	●
High-mounted stop lamp (LED type)	●	●	●	●
Chrome insert on lower front grille	—	●	●	●
Body-coloured, heated and electric door mirrors	●	●	●	●
Retractable door mirrors	—	—	●	●
Indicator integrated in door mirror	●	●	●	●
Power door locking	●	●	●	●
Remote door locking	●	●	●	●
Electric boot release	●	●	●	●
Body-coloured roof spoiler	●	●	●	●
Intermittent front and rear wipers	●	●	●	●
Body-coloured door handles	●	●	●	●
Privacy glass	●	●	●	●
Roof antenna	●	●	●	●
Front and rear parking sensors	○	○	○	●
Rain-sensing wipers and dusk-sensing headlights	—	●	●	●
Rear-view camera	—	●	●	●

● = Standard

○ = Optional

— = Not available

\* 2.0i 2WD only.

## COMFORT

	Active (2WD only)	Business Edition (2WD only)	Icon	Invincible
3-spoke leather steering wheel	—	●	●	●
Leather gear shift knob	—	●	●	●
Leather parking brake with chrome button	—	●	●	●
Manual tilt and telescopic steering wheel	●	●	●	●
Power steering	●	●	●	●
Stop & Start System	●	●	●*	●*
Keyless entry & push-button start	—	—	●	●
Illuminated entry system	●	●	●	●
Cruise control	—	●	●	●
Sport mode button (AWD only)	—	—	●	●
Manual rear-view mirror	●	—	—	—
Auto-dimming rear-view mirror	—	●	●	●
Manual air conditioning	●	—	—	—
Dual-zone Climate Control air conditioning	—	●	●	●
Electric headlamp levelling	●	●	●	●
Soft instrument panel	—	●	●	●
Leather-like instrument panel	—	●	●	●
Luggage room lamp	●	●	●	●
Fabric door trim	●	—	—	—
Leather-like door trim	—	●	●	●
Anti-jam protection on power windows	●	●	●	●
Auto up & down function on driver's window	●	●	●	●
Rear power windows	●	●	●	●
Front personal lamp	●	●	●	●
Chrome inside door handles	●	●	●	●
Driver and passenger sun visors with mirror	●	●	●	●



# Equipment

## COMFORT

	Active (2WD only)	Business Edition (2WD only)	Icon	Invincible
Front and rear assist grips	●	●	●	●
Eco Mode	—	—	●*	●*
Rear window defogger	●	●	●	●
Immobiliser	●	●	●	●
2 x 12V power outlets	●	●	●	●
60:40 split-folding rear seats	●	●	●	●
Easy flat system	●	●	●	●

## SEATS

	Active (2WD only)	Business Edition (2WD only)	Icon	Invincible
Sliding front seats	●	●	●	●
Reclining rear seats	●	●	●	●
Power height-adjustable driver's seat	—	—	—	●
Power-adjustable driver's seat	—	—	—	●
Height-adjustable driver's seat	●	●	●	—
Power lumbar support for driver's seat	—	—	—	●
Rear headrests	●	●	●	●
Full leather seats with heated front seats	○	○	○	●

## STORAGE

	Active (2WD only)	Business Edition (2WD only)	Icon	Invincible
Locking glovebox	●	●	●	●
Console box	●	●	●	●
Front and rear cup holders	●	●	●	●
Coat hooks	●	●	●	●
Driver and passenger seatback pockets	●	●	●	●
Horizontal cargo net	●	●	●	●
Retractable tonneau cover	●	●	●	●

INFO & AUDIO	Active (2WD only)	Business Edition (2WD only)	Icon	Invincible
Toyota Touch® 2 multimedia	—	●	●	●
Toyota Touch® 2 with Go navigation	—	●	○	○
Toyota Touch® 2 with Go Plus navigation	—	—	○	○
Audio and telephone switches on steering wheel	●	●	●	●
DAB radio	—	●	●	●
Bluetooth® connectivity	●	●	●	●
Radio and CD player with WMA and MP3 capabilities	●	●	●	●
4 speakers	●	—	—	—
6 speakers	—	●	●	●
Aux-in and USB connectors	●	●	●	●

SAFETY	Active (2WD only)	Business Edition (2WD only)	Icon	Invincible
<b>Active Safety</b>				
Anti-lock Braking System (ABS) with Electronic Brake force Distribution (EBD) and Brake Assist (BA)	●	●	●	●
Vehicle Stability Control (VSC)	●	●	●	●
Downhill Assist Control (DAC)	—	—	●*	●*
Hill-start Assist Control (HAC)	●	●	●	●
<b>Passive Safety</b>				
Supplemental Restraint System (SRS) airbags – 7 airbags	●	●	●	●
Front passenger airbag on/off switch	●	●	●	●
ISOFIX seat fixing	●	●	●	●
Pre-tensioners and force limiters	●	●	●	●
Child protection locks	●	●	●	●

● = Standard    ○ = Optional    — = Not available

\* Standard on 2.0i Valvematic Auto (CVT), 2.2i D-CAT 150.

# Toyota Touch® 2 packages

INTERFACE	Toyota Touch® 2	Toyota Touch® 2 with Go	Toyota Touch® 2 with Go Plus
High resolution touchscreen with drag & flick operation	●	●	●
Display size	6.1"	6.1"	6.1"
Languages	20	20	20

AUDIO & CONNECTIVITY	Toyota Touch® 2	Toyota Touch® 2 with Go	Toyota Touch® 2 with Go Plus
Bluetooth® connectivity for mobile phone calls and music streaming	●	●	●
USB/AUX connector	●	●	●
MP3 & iPod® integration	●	●	●
Album cover art	iPod®/USB	iPod®/USB	iPod®/USB
SMS/email	●	●	●
Phone book contact picture display	—	●	●
CD player with MP3/WMA capabilities	●	●	●
AM & FM tuner	●	●	●
Digital radio option (DAB/DAB+)	●	●	●

SATELLITE NAVIGATION	Toyota Touch® 2	Toyota Touch® 2 with Go	Toyota Touch® 2 with Go Plus
Full EU map navigation	—	●	●
2D/3D map view	—	●	●
Speed limit warnings	—	●	●
Fixed speed camera warnings	—	●	●
RDS-TMC traffic information	—	●	●
Point Of Interest search (on board)	—	●	●



TOYOTA ONLINE SERVICES & APPLICATIONS*	Toyota Touch® 2	Toyota Touch® 2 with Go	Toyota Touch® 2 with Go Plus
Toyota Real-Time Traffic <sup>§</sup>	—	●	●
Online Local Search <sup>§º</sup> (Google Places, Yandex, TomTom Places, Nokia here)	—	●	●
Google Street View™ <sup>§</sup>	—	●	●
Panoramio™ <sup>§</sup>	—	●	●
Weather <sup>§</sup>	—	●	●
Fuel prices <sup>§</sup>	—	●	●
Parking <sup>§</sup>	—	●	●
Glass of Water**	—	●	●
Park&Go**	—	●	●
Twitter**	—	●	●
AUPEO!**	—	●	●
Coyote**	—	●	●

OTHER	Toyota Touch® 2	Toyota Touch® 2 with Go	Toyota Touch® 2 with Go Plus
Vehicle info (A/C status, trip info, fuel consumption, HV monitor)	●	●	●
3 years' free map updates (2 per year)	—	—	●
3D city models and landmark graphics	—	—	●
Text-to-speech message readout facility	—	—	●
Emails and calendar display	—	—	●

● = Standard      — = Not available

\* Toyota Portal Account required .

§ Mobility Pack content, subscription required, free 1-year trial period.

º Online local search availability depending on markets.

\*\* Paid application.

# Owning your new RAV4.

## **Servicing your Toyota**

Toyota Fixed Price Servicing means you will be sure to know the cost of your service up front. Expertly trained technicians using only genuine Toyota parts will carry out your service at one of over 200 Authorised Toyota Service Centres. The technicians will advise you on the correct service for your car based on the car's age, mileage and service history.

For more information visit [toyota.co.uk/service](http://toyota.co.uk/service)

## **Service Plans**

Inflation-proof pricing with a monthly or one-off payment plan means one less thing to worry about. With Toyota Service Plans the price you're quoted is guaranteed for the duration of your plan. The service, parts and labour are all paid for either in monthly instalments or as a one-off payment at the beginning of your plan.

For more information visit [toyota.co.uk/service](http://toyota.co.uk/service)

## **Toyota Fixed Price Repairs using Genuine Parts**

We offer fixed prices on a number of repair items for your Toyota giving you peace of mind when it comes to managing costs. Also don't forget we only use genuine Toyota parts, all of which come with at least 12 months' warranty (some even offer unlimited mileage warranties); and your car will always be dealt with by a trained Toyota Technician.

For more information visit [toyota.co.uk/repairs](http://toyota.co.uk/repairs)

## **MyToyota**

This is a new and unique online Toyota customer portal that keeps track of everything you need to know about your car. You can sign up to **MyToyota** at [toyota.co.uk/mytoyota](http://toyota.co.uk/mytoyota). Once you're up and running you can benefit from MOT and service reminders, access your car's service history and obtain details for your Toyota Roadside Assistance alongside much more information about your car.

## **Toyota Rewards**

Another benefit of signing up to **MyToyota** is access to Toyota Rewards. We've teamed up with big brands such as Virgin Holidays, Ticketmaster, Superbreak and many more to give you special offers on things you'll like doing and places you'll like going to in your Toyota.

## **Toyota Accessories**

Toyota accessories are designed and manufactured with the same care, quality and attention to detail as Toyota vehicles. Tailor-made for your Toyota, they fit perfectly and add a personal touch of style, comfort and practicality. Also, because they've been tested under the most severe conditions, you can have complete confidence in their reliability and durability. To add to the reassurance, every genuine Toyota accessory has a 5-year warranty when purchased together with the vehicle.

For more information visit [toyota.co.uk/accessories](http://toyota.co.uk/accessories)

## **Toyota Roadside Assistance**

When you buy a Toyota you will automatically receive 12 months' AA Roadside Assistance in the UK and Europe, free of charge; after the first year the cost of Toyota Roadside Assistance is £6 per month when paid by monthly Direct Debit, £68 per annum if paid by annual Direct Debit or £72 per annum when paid by all other payment methods.

For full terms and conditions please visit [toyota.co.uk/roadsideterms](http://toyota.co.uk/roadsideterms)

## **5-Year Toyota Warranty**

Every new Toyota comes with a 5-year/100,000-mile (whichever comes first) manufacturer's warranty, covering you against the unlikely event of a manufacturing defect causing a mechanical fault.

For full details, please ask your official Toyota Centre or visit [toyota.co.uk/5yearwarranty](http://toyota.co.uk/5yearwarranty)

## **Corrosion Cover**

The 12-year unlimited mileage cover protects against rust perforation affecting sheet metal body panels as a result of a manufacturing fault. This warranty can also be transferred to any future owner throughout the 12-year period.

## **Rust and Paint Cover**

The 3-year unlimited mileage cover protects against defects and surface rust as a result of a manufacturing fault.

### **Toyota Extended Warranty**

You have the choice of either the unlimited mileage cover or the low-user option that restricts you to 10,000 miles per year. You also have a choice between 12 and 24 months' cover (subject to vehicle eligibility). The 24-month option will show a saving over two 12-month Toyota Extended Warranty policies and is available with the low-user option at 10,000 miles per year over 24 months.

The Toyota Extended Warranty can be renewed until the vehicle is eight years old, and if a part covered by the Toyota Extended Warranty suffers electrical or mechanical failure at any time during the term, Toyota is committed to fixing it. You don't pay for replacement parts or labour.

For more information visit [toyota.co.uk/extendedwarranty](http://toyota.co.uk/extendedwarranty)

### **Toyota Motor Insurance**

Toyota Motor Insurance is available for Toyota owners at competitive premiums. To obtain details of the benefits included and to arrange a quotation, please contact your local Toyota Centre or call 0800 350 500.

### **Flexible Finance from Toyota Financial Services**

All our plans offer easy budgeting and peace of mind and **AccessToyota** brings these benefits together in one flexible package.

Toyota Financial Services, Great Burgh, Burgh Heath, Epsom, Surrey, KT18 5UZ.

Finance subject to status to over 18s only. Indemnities may be required. Terms and conditions apply.

TFS is authorised and regulated by the Financial Conduct Authority.



**TOYOTA**  
FINANCIAL  
SERVICES







Point your smartphone or webcam at the graphic and start a new experience of RAV4.



ALWAYS A  
**BETTER** WAY

To experience the RAV4 or for more information on the vehicle, Toyota and the environment or our latest offers, please contact your local Toyota Centre or visit our website **[toyota.co.uk/rav4](http://toyota.co.uk/rav4)**

While every effort is made to reproduce accurate information, we reserve the right to change specifications, equipment and availability without prior notice. This brochure cannot be regarded as infallible (some of the vehicles shown may not be to exact UK specification), and as such does not constitute an offer for sale of any particular vehicle or specification. For the latest specification and availability, we ask that you contact your local Toyota Centre.

Quoted mpg and CO<sub>2</sub> figures: All mpg and CO<sub>2</sub> emissions figures quoted in this brochure are sourced from official EU-regulated test results. These are provided for comparability purposes only and may not reflect your actual driving experience. Fuel consumption varies significantly depending on a number of factors, including driving style, conditions, speed and vehicle weight. In order to allow consumers to compare and make an informed choice between one vehicle and another, there is a European Commission standard (93/116/EC and 692/2008) to measure fuel consumption. This common standard must be adhered to by all manufacturers selling motor vehicles in the EU and is the basis for fuel consumption figures published by each manufacturer. For further information please visit [www.dft.gov.uk/vca/fcb/faqs-fuel-consumptio.asp](http://www.dft.gov.uk/vca/fcb/faqs-fuel-consumptio.asp) or speak to your local Toyota Centre.

The use of the term 'Toyota Accessories' should not be taken to imply that the products on the accessory pages are actually manufactured by the Toyota Motor Corporation or Toyota (GB) PLC. The After Sales Division is continually updating and changing specifications of accessories and reserves the right to do so at any time without prior notice.



Toyota UK



@ToyotaGB

GBNGV-0615B-RV July 2015